

HEAD - MARINE SANITATION DEVICE (MSD)

The federal law requiring a Coast Guard approved marine sanitation device is now in effect, although no one is certain of its enforcement. The Coast Guard says it will not board boats solely to inspect MSDs, but may carry out a head inspection if boarding for any other reason, such as answering distress calls. The Marine Police say this is none of their business, and they will not enforce this law. A court suit has been filed to overturn the law, and many legal questions (search warrants? for example) remain to be answered under the law.

Compliance may be achieved with a "porta-potty" type of device, available in camping and marine supply stores; various "Type I" MSDs which discharge treated wastes overboard, such as the "Lectra-San" (with high current drain) and one-piece types using chemical tablets or liquid (with much lower current drain, but much more expensive); and "Type III" holding tanks with deck pump-out fittings (and some with Y valves for either overboard discharge or deck pump-out, about which there is legal controversy). (For the record, there is also a "Type II" MSD, which is the most complicated and the most expensive.) Before purchasing any type of MSD, take careful measurements to insure that it will fit into the available space.

I installed an "Lectra-San" in my boat, and it is relatively easy to do. I used the same toilet bowl and hand pump, and I put the treatment tank in the V-locker just aft the water tank in the forward compartment. Hoses connect the tank to the toilet bowl and to the overboard discharge thru-hull fitting. The electric hookup is made with wires running under the cabin sole (in the drain channel to the bilge) to the battery. The control unit is mounted in the head compartment itself. It's difficult to describe, so I invite anyone interested to visit my boat.

- Art Levin

Zahniser's in Solomons, Md., will sell and install the "Lectra-San" for \$525. The last "BOAT-US" price of the "Lectra-San" was \$360.

- Sid Rosen

This is our head arrangement:

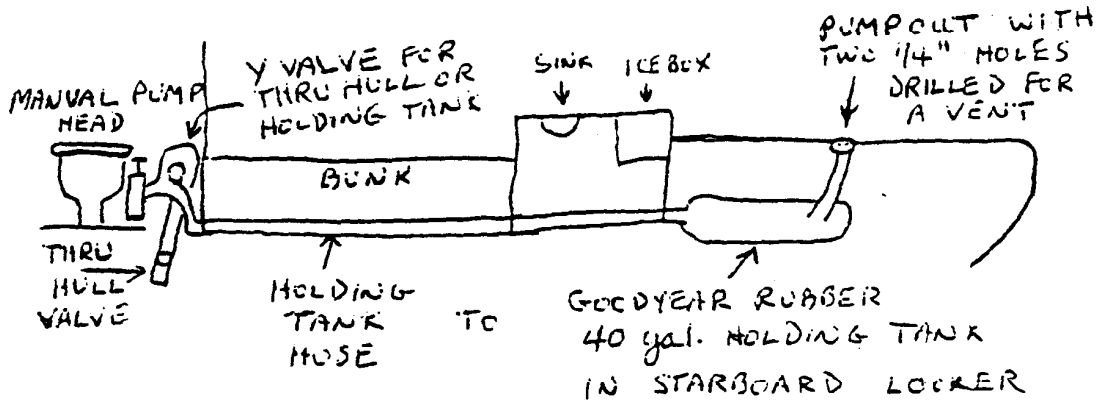

I called the CG here in Ct. and they said this system (with the Y valve) is completely legal and up to date with the new head regulations.

- Jim Ranti

A small quantity (the container cap full) of "Sealube" in the toilet bowl water once or twice a month will lubricate and soften the washer in the toilet pump. Vegetable or other oil will serve to lubricate temporarily in an emergency.

- Art Levin

We installed a Mansfield TDX-2 MSD. The tank is in the large locker under the V-berths. The panel between the berths must be moved aft about 8 inches. We were careful not to damage it, and it now slides in rails, much like the cabin access to the engine. The pump is under the head of the starboard bunk. It is necessary to reduce the depth of the medicine cabinet and basin platform in order to make room for the inboard loop. We had to rotate the head clockwise so the discharge from the hand pump would clear the overhead valve. This was a major job, but a very satisfactory one. Very little of the gear is visible, and we think that the restored areas look better than before.

- Bruce Carr

Here's how I tackled the head problem -- at least to my satisfaction, short of throwing the damn thing over the side. A six-gallon polypropelene outboard fuel tank fits very neatly into my V-berth compartment, just aft of the water tank. I've fitted the tank with an inspection port and a delrin thru-hull that connects to the discharge hose of the toilet via a Y-valve. It's neat, the fuel gauge gives you a level indicator, and the vent fitting allows for a little more class than a Jerry jug or an oak bucket. It lifts out easily, and should be adequate for most folks' needs. As far as I can tell, it meets the requirements of the law, and is basically inexpensive.

- Jim Turse

Parts for the "Brydon Boy" marine toilet (B9128) may be obtained from some marine supply stores. If not available, the home office is Brydon Division ITT Industries of Canada, Ltd., 168 Rexdale Blvd., Rexdale, Ontario, Canada M9W IP6, (416) 743-8671. The western U.S. distributor is Jabsco Products ITT, 1485 Dale Way, Costa Mesa, CA 92626, (714) 545-8251. The eastern U.S. distributor is Jabsco Products ITT, 501 West Liberty Street, Springfield, OH 45501, (513) 325-8701. The Seal and Gasket Repair Kit (internal parts) number is 59300-1002. The Fastener Repair Kit number is 59300-1001; Pump body # 591277049.

* * *

Installed a PAR electric conversion kit on the head. Draws a lot of amps, but it is sure nice to push that little button to flush.

- Herb Edwards



We installed a 14-gallon flexible holding tank, "Y" valve, and Guzzler pump in the head compartment. The holding tank went outboard of the head below the wash basin. Unfortunately, the Guzzler pump had to go into the hanging locker just forward of the head, but it all fits, and makes us legal with the USCG, et al.

- Bob & Cleo Phillips

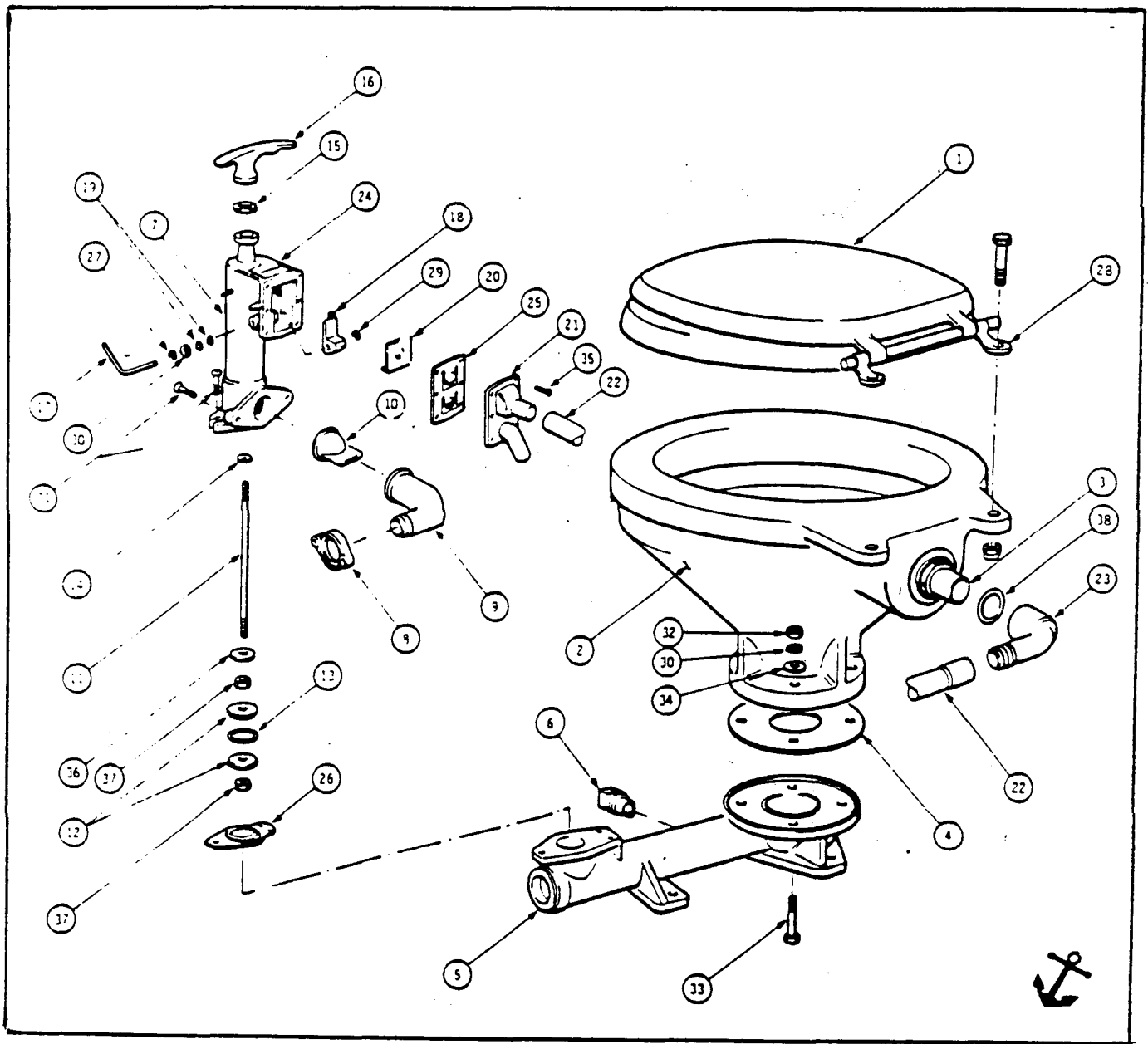

For further information, please contact the BRYDON/PAR/JABSCO distributor in your area, or call:

Jabco Products ITT
 1485 Dale Way
 Costa Mesa, California
 U.S.A. 92626
 Telephone: (714) 545-8251

ITT Brydon
 168 Rexdale Boulevard
 Rexdale, Ontario
 CANADA M9W 1P6
 Telephone: (416) 743-8671

Jabco Products ITT
 501 West Liberty Street
 Springfield, Ohio PO Box 32;
 U.S.A. 45501
 Telephone: (513) 325-8701

PAR™
Brydon

MARINE TOILET W.C. MARIN

MODELS: 59128-0000
59128-0100
MODELES: 50745-3773

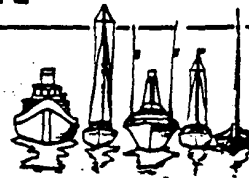

INSTALLATION INSTRUCTIONS	OPERATING INSTRUCTIONS
<p>This manual toilet may be installed above or below the waterline. Seacocks should be used for intake and discharge hull fittings. Securely fasten all four mounting feet on flat surface.</p> <p>PLUMBING CONNECTIONS. Make sure all inlet connections are airtight and free of sharp bends or restrictions. Discharge hose should be as direct as possible and free of sharp bends or restrictions. Use heavy wall non-collapsible hose or tubing.</p> <p>For installations below waterline, use vented loop about 8" above waterline at all angles of heel or trim for both intake and discharge hoses.</p> <p>For installations above waterline, make a loop in the discharge line about 8" above base of bowl to retain water in bowl.</p>	<p>Make sure inlet and discharge seacocks or valves are open. Move valve lever to "Flush" position and operate pump, return valve lever to "Dry Bowl" position and empty bowl. Leave valve lever in "Dry Bowl" position when toilet is not in use. Close seacocks when boat is unattended.</p> <p>To drain for winter lay-up, remove drain plug in the base and operate pump with valve lever in "Dry Bowl" position. In salt water areas, a thorough flushing with fresh water will assure troublefree use the following season. Do not use anti-freeze, acids, harsh alkalis, javex or household bleaches in cleaning. After long period of non-use, the inside surface of the pump cylinder may be given thin coating of vaseline to assist in operation.</p>

PARTS LIST

KEY	PART No.	DESCRIPTION	KEY	PART No.	DESCRIPTION
1.	59127-7001	Seat & Cover	18.	59127-7021	Valve Cam
	59127-7101	Seat & Cover**	19.	59127-7023	Valve Handle O-Ring Seal
2.	59127-8002	Bowl	20.	59127-7026	Intake Valve Seal
	59127-8102	Bowl**	21.	59127-7027	Valve Housing Cover
3.	59127-7057	Spud		59127-7127	Valve Housing Cover**
4.	59127-7004	Bowl Gasket B	22.	59127-7029	Hose
5.	59128-7001	Base		59127-7129	Hose**
	59128-7101	Base**	23.	59127-7030	Intake Elbow
6.	59127-7006	Base Drain Plug A		59127-7130	Intake Elbow**
7.	59127-7009	Pump Cylinder		59127-7043	Intake Elbow & Hose Assembly
	59127-7109	Pump Cylinder**		59127-7143	Intake Elbow & Hose Assembly**
	59127-7049	Cylinder C/W Seal & Label	24.	59127-7033	Instruction Decal
	59127-7149	Cylinder C/W Seal & Label**	25.	59127-7040	Double Valve Gasket B
	59127-7050	Pump Unit, Complete	26.	59127-7041	Base Flap Valve Gasket B
	59127-7150	Pump Unit, Complete**	27.	59127-7042	Control Handle Ret. Ring
8.	59127-7011	Discharge Flange	28.	59127-7047	Hinges C/W Nuts & Bolts
	59127-7111	Discharge Flange**		59127-7147	Hinges C/W Nuts & Bolts**
9.	59127-7012	Discharge Elbow	29.	59127-7052	Cam. Ret. Ring
	59127-7112	Discharge Elbow**	30.	91603-0900	1/4" St. Steel Washer A
10.	59127-7013	Joker Valve B	31.	57000-8510	1" x #14 S.S. Tap Screw A
11.	59127-7014	Piston Rod	32.	91805-0050	1/4-20 Brass Nuts, Plated A
12.	59127-7015	Piston	33.	57000-8396	1/4-20 x 1-3/4" Hex. S.S. Bolts A
13.	59127-7016	Piston O-Ring B	34.	57000-8195	11/16" Plastic Washer A
14.	59127-7017	Seal B	35.	57000-8515	3/4" x #10RH S.S. Tap Screw A
15.	59127-7018	Bumper Washer B	36.	57000-8160	3/8" Brass Washer
16.	59127-7019	Pump Handle	37.	57000-8105	3/8"-16 Hex. Brass Nut
17.	59127-7031	Valve Control Handle	38.	59127-7051	Intake O-Ring

NOTE: A. PARTS INCLUDED IN FASTENER REPAIR KIT 59300-1001
B. PARTS INCLUDED IN SEAL AND GASKET REPAIR KIT 59300-1002
**BONE COLOUR